



www.estesrockets.com

ESTES® INDUSTRIES  
1295 H Street  
Penrose, CO 81240  
PRINTED IN CHINA

NO.2

# Sky Writer™

FLYING MODEL ROCKET KIT INSTRUCTIONS  
KEEP FOR FUTURE REFERENCE.

FOR KITS:  
EST 1235  
EST 1260



## ASSEMBLY TIP

Read all instructions before beginning work on your model. Make sure you have all parts and supplies. **TEST-FIT ALL PARTS TOGETHER BEFORE APPLYING ANY GLUE.** If any parts don't fit properly, sand as required for precision assembly.

## PARTS:

Locate the parts shown below and lay them out on the table in front of you. **DO NOT USE THIS DRAWING TO ASSEMBLE YOUR ROCKET.**

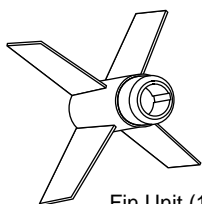
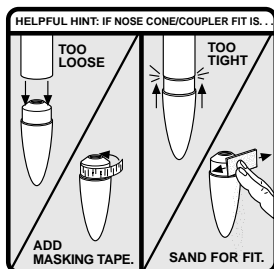
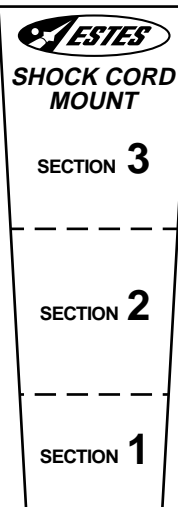

Fin Unit (1)  
72614

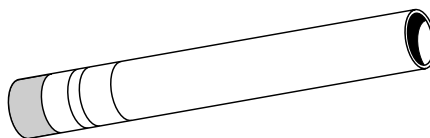

Lower Body Tube - BT-50 (1)  
(60158)

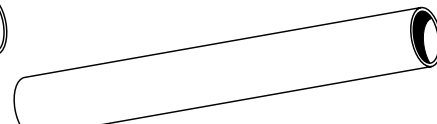

Upper Body Tube - BT-50 (1)  
(30349)

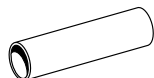

Blue Engine  
Mount Tube (1)  
(30326-1)



Green Engine  
Block (1)  
(30162-2)



Black Engine  
Holder Ring (1)  
(30120-3)



Nose Cone (1)  
(71027)



Green Adaptor  
Ring (1)  
(30165-2)



Launch Lug (1)  
(38175)

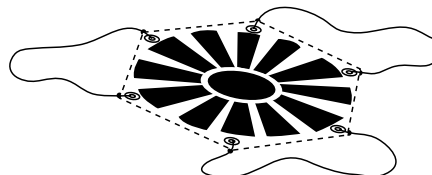

Assembled 12" (30 cm) Parachute  
(35801)



Red Tube  
Coupler (1)  
(30174-5)



Engine Hook (1)  
(35021)



Shock Cord (1)  
(38374)



Decal Sheet (1)  
(60160)

## SUPPLIES REQUIRED:



HOBBY KNIFE



PLASTIC  
CEMENT



CARPENTER'S  
GLUE



SPRAY CLEAR  
COAT  
(OPTIONAL)



PENCIL



RULER



SCISSORS



FINE  
SAND PAPER  
(#400-600 GRIT)



MASKING  
TAPE

ALL GLUED AREAS ARE SHADED IN GRAY

# 1. ENGINE MOUNT ASSEMBLY

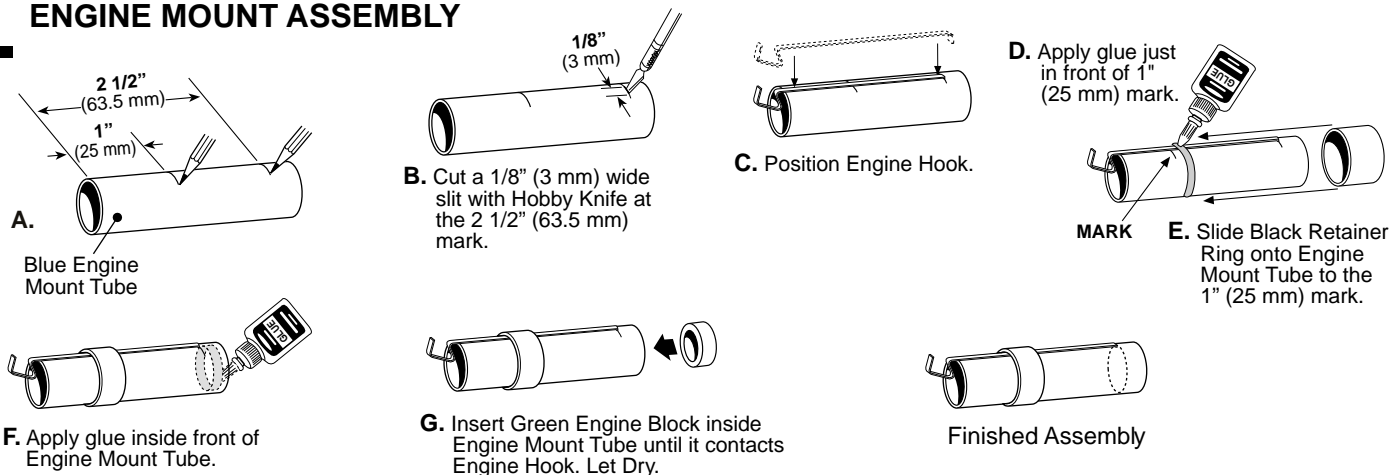

# 2. FIN UNIT ASSEMBLY

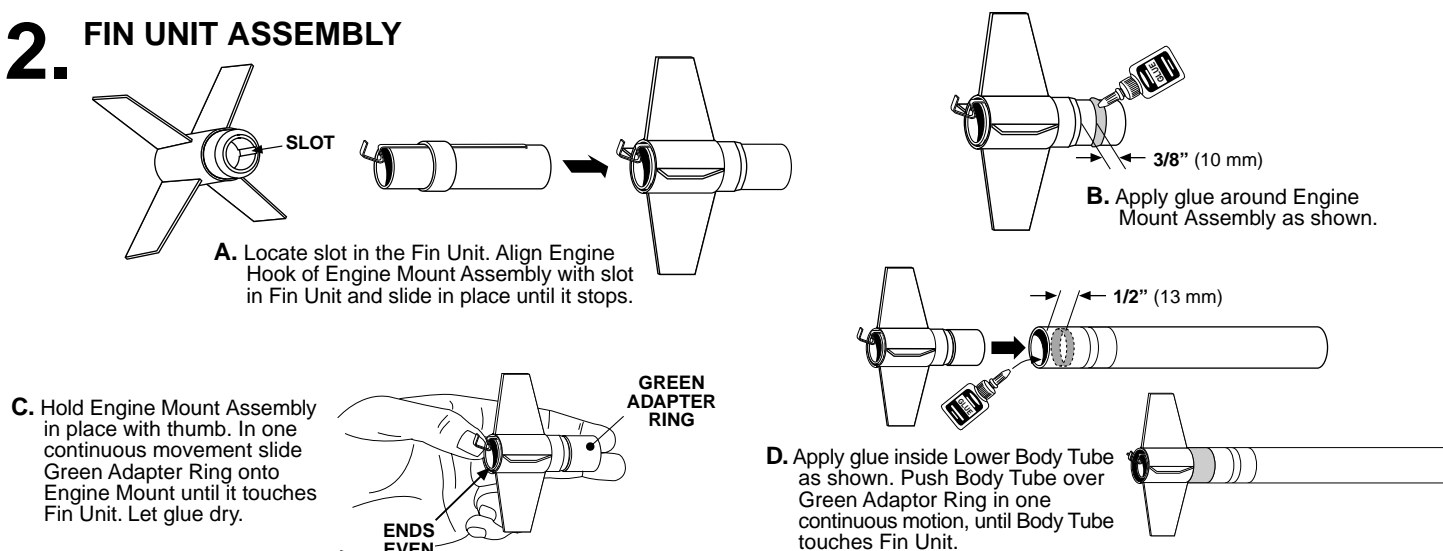

# 3. BODY TUBE ASSEMBLY

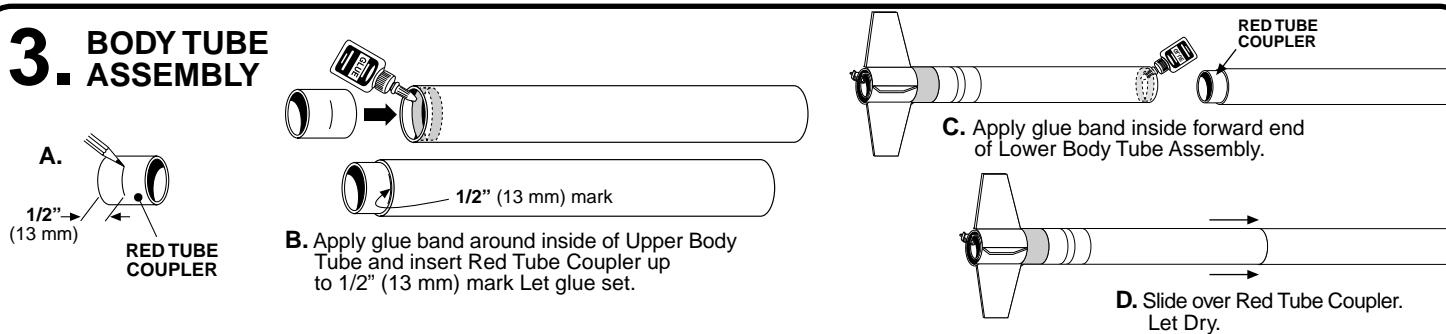

# 4. ATTACHING LAUNCH LUG

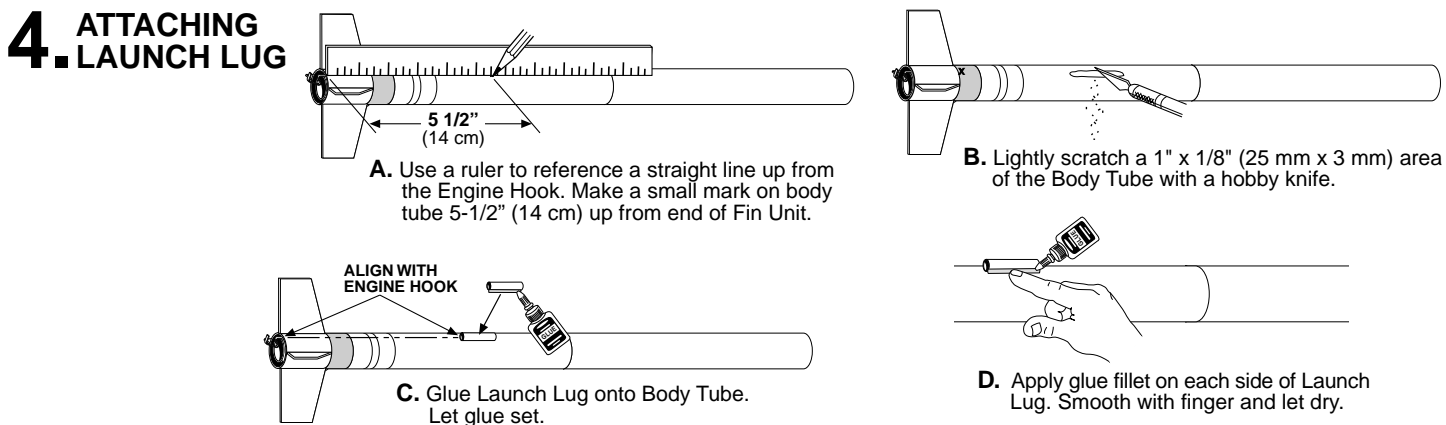

## 5. ATTACHING SHOCK CORD

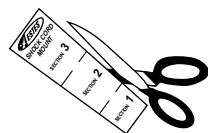

A. Cut out Shock Cord Mount from front page.

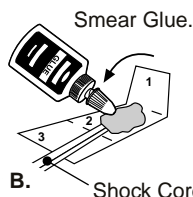

B. Shock Cord

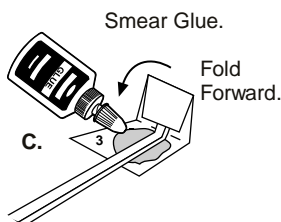

C.

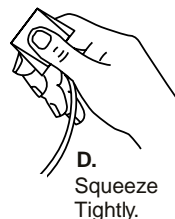

D. Squeeze Tightly.

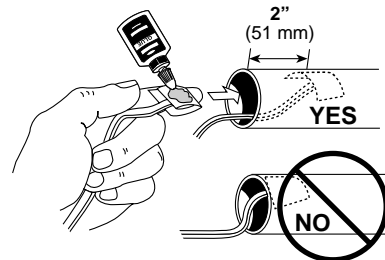

E. Glue Mount inside Body Tube. Hold until glue sets. Let glue dry completely.

## 6. ATTACHING PARACHUTE & SHOCK CORD

A. Remove FLASH from eyelet of Nose Cone.

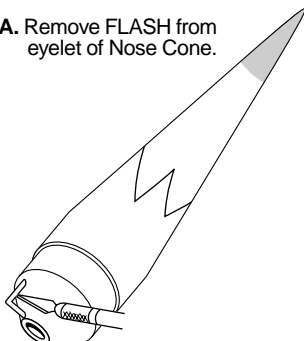

**CAUTION:**  
DO NOT CUT OFF EYELET OF NOSE CONE.

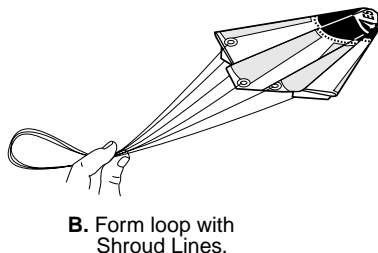

B. Form loop with Shroud Lines.

C. Push loop through eyelet of Nose Cone.

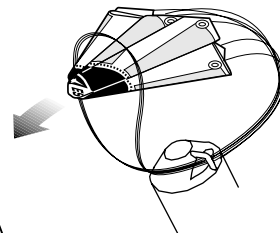
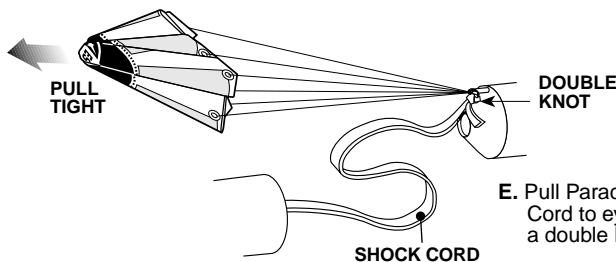

D. Pass Parachute through loop.

E. Pull Parachute tight. Tie Shock Cord to eyelet of Nose Cone with a double knot.



## 7. DECAL APPLICATION

DECAL

Carefully remove Decal from sheet and apply where shown. Rub down to remove bubbles.



**OPTIONAL:** Clear coat entire rocket after applying decal.

## ROCKET PREFLIGHT

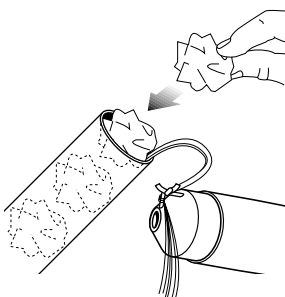

A. Insert 3-4 loosely crumpled squares of Recovery Wadding.

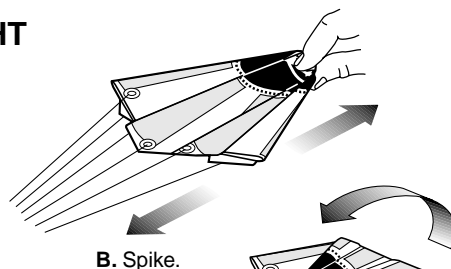

B. Spike.

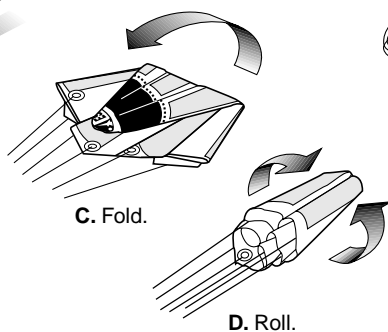

C. Fold.

D. Roll.

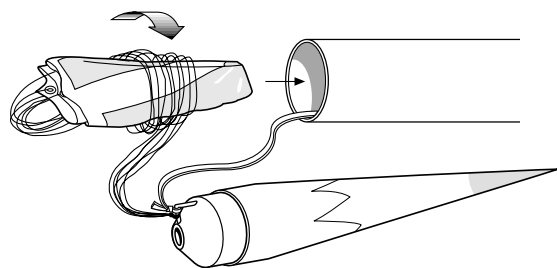

E. Wrap lines loosely, insert Parachute, Shock Cord and Nose Cone.

# ENGINE PREP

**WARNING: FLAMMABLE**  
Before proceeding read instructions  
& NAR Safety Code included  
with engines.  
**PREPARE YOUR ENGINE**  
**ONLY WHEN YOU ARE**  
**OUTSIDE AT THE LAUNCH**  
**SITE PREPARING TO LAUNCH!**  
If you do not use your prepared  
engine, remove the igniter before  
storing your engine.

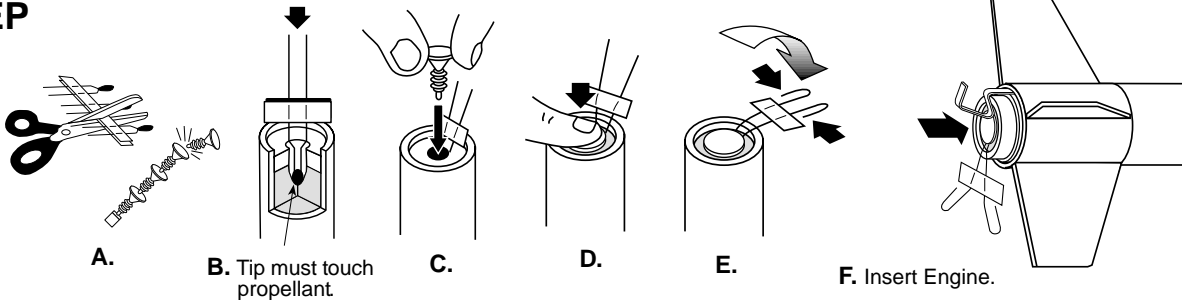

## COUNTDOWN AND LAUNCH

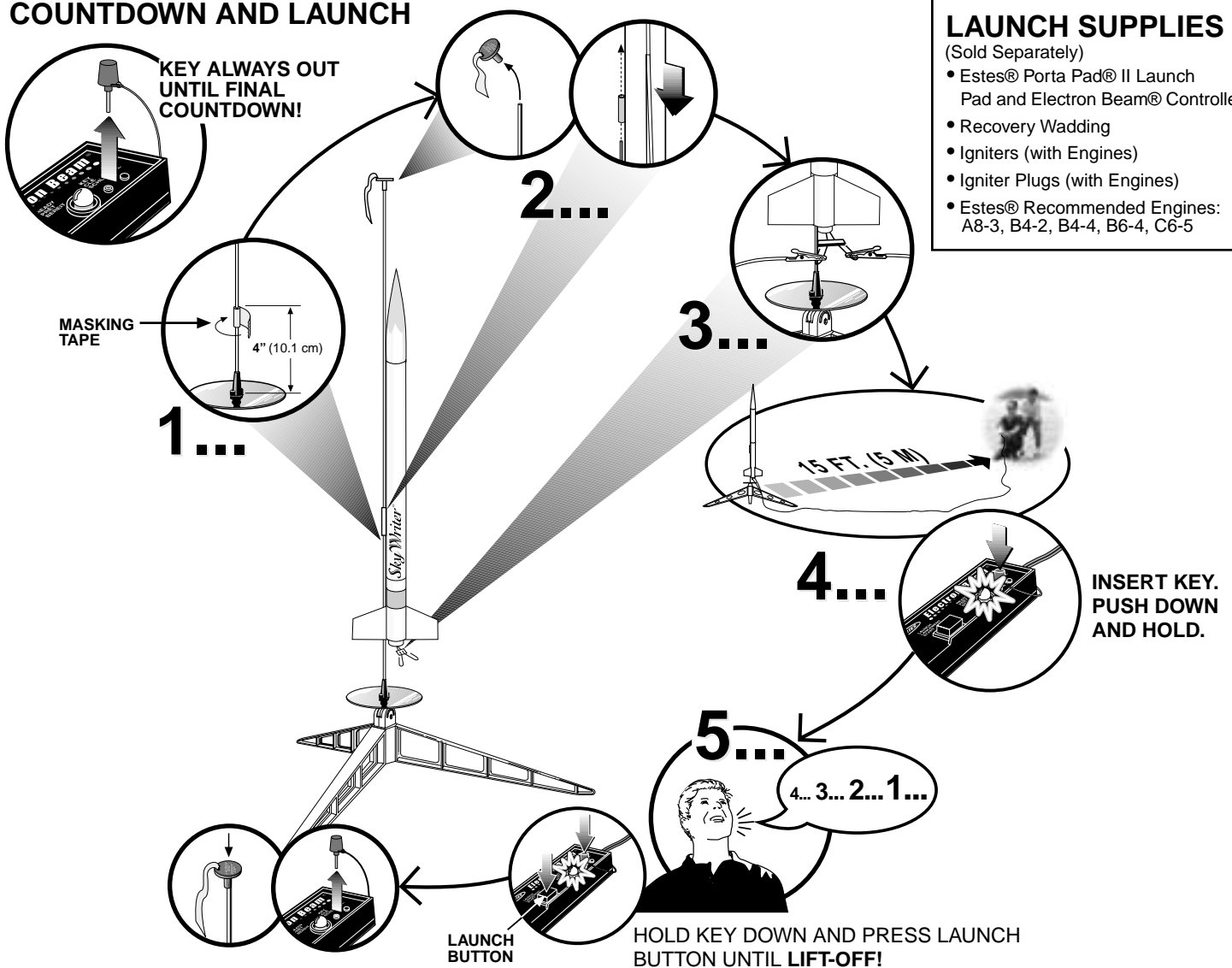

## LAUNCH SUPPLIES

(Sold Separately)

- Estes® Porta Pad® II Launch Pad and Electron Beam® Controller
- Recovery Wadding
- Igniters (with Engines)
- Igniter Plugs (with Engines)
- Estes® Recommended Engines: A8-3, B4-2, B4-4, B6-4, C6-5

## PRECAUTIONS

NAR Safety Code



## FLYING YOUR ROCKET

Choose a large field (500 ft. [152 m] square) free of dry weeds and brown grass. The larger the launch area, the better your chance of recovering your rocket. Football fields and playgrounds are great. Launch only with little or no wind and good visibility.

Always follow the National Association of Rocketry (NAR) SAFETY CODE.

## MISFIRES

**TAKE THE KEY OUT OF THE CONTROLLER. WAIT ONE MINUTE BEFORE GOING NEAR THE ROCKET!** Disconnect the igniter clips and remove the engine. Take the plug and igniter out of the engine. If the igniter has burned, it worked but did not ignite the engine because it was not touching the propellant inside the engine. Put a new igniter all the way inside the engine without bending it. Push the plug in place. Repeat the steps under Countdown and Launch.